

# RESTAURANT AVAILABLE

Route 73 & Fellowship Road, Mount Laurel, NJ

**+/- 8,500 SF**  
**Adjacent to**  
**"W" Aloft Hotel**

- Great demographics
- Strong daytime population
- Easy access & great visibility
- 1730 Hotel rooms within a 1/2 mile
- Pylon sign



**Contact:**  
**David Orkin**  
 orkin@rasbrokerage.com



Proposed Rendering

**RAS**  
 BROKERAGE

633 West Germantown Pike; Suite 203  
 Plymouth Meeting, PA 19462  
 Phone: 215.322.8070  
 Fax: 215.322.8460

## SITE PLAN

**RAS**  
 BROKERAGE

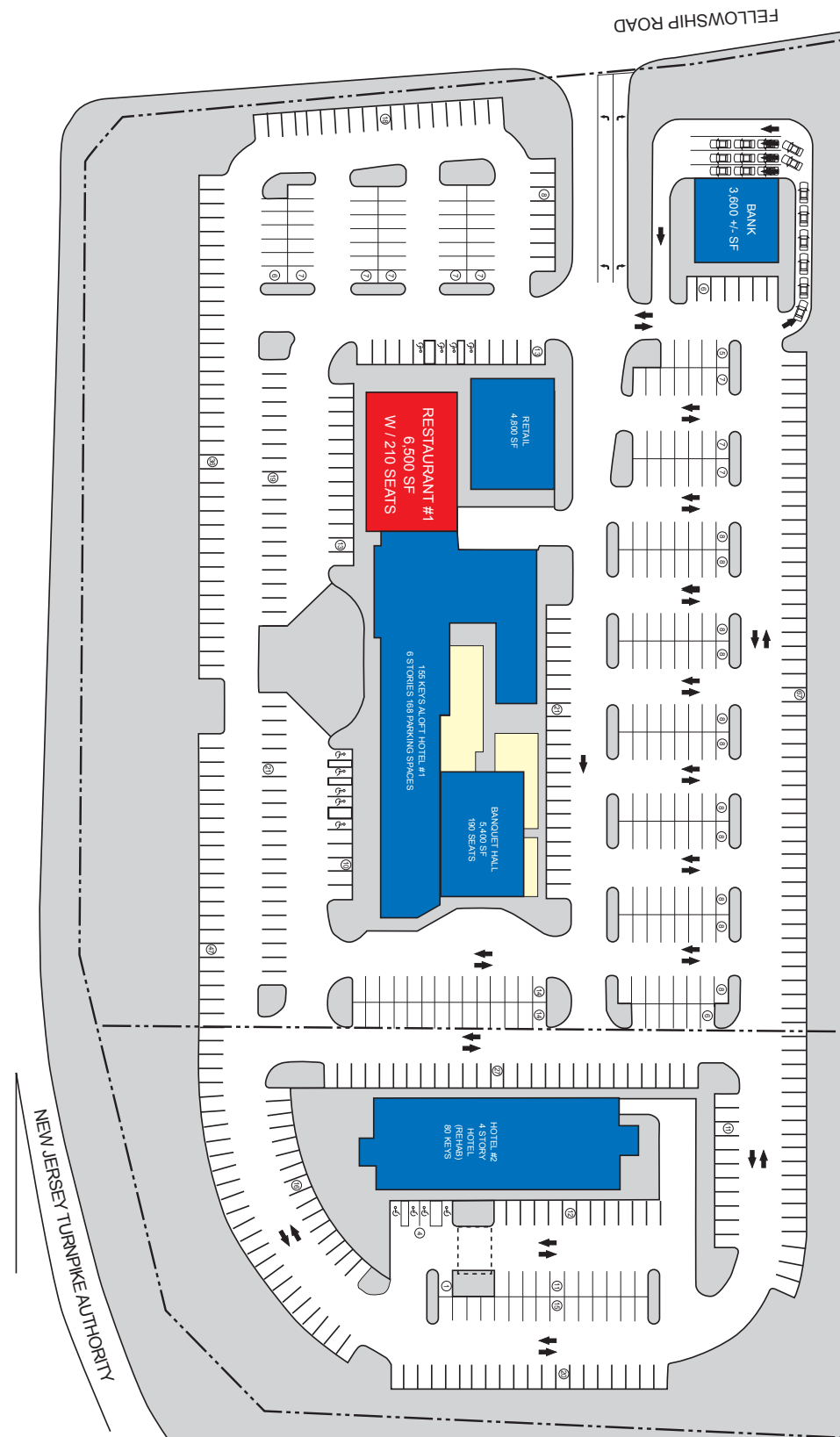

	1 mile	3 miles	5 miles
Population:	4,198	86,016	217,951
Med HH Inc:	\$74,489	\$76,845	\$83,032
Daytime Pop:	15,035	75,302	161,527

All information furnished regarding property for sale, rental or financing is from sources deemed reliable, but no warranty or representation is made as to the accuracy thereof and same is submitted subject to errors, omissions, change of price, rental or other condition, prior to sale, lease or financing or withdrawal without notice. No liability of any kind is to be imposed on the broker herein.

